



Local Dealer:

Phone Number:

Truss Pricelist Buildings

Your satisfaction is what keeps us going!

Michigan

Free Installation



- Structural engineered designed for added strength
- Before you buy anywhere else, compare our installation schedules and value-added standard features!
- Free delivery & installation!
- We also have a wide selection of 12'-30' wide economy buildings.
- Customer will be required to provide a TELESCOPIC LIFT during the installation.

PRICES STARTING AT \$10,272

A-FRAME VERTICAL ROOF WITH 8 FT. LEGS STANDARD WITHOUT SIDE SHEET METAL

STANDARD 14 GAUGE 2 1/2" STEEL

	32'W	34'W	36'W	38'W	40'W	42'W	44'W	46'W	48'W	50'W	52'W	54'W	56'W	58'W	60'W
21'	\$10,272	\$10,608	\$11,310	\$11,844	\$12,546	\$13,434	\$14,136	\$14,844	\$15,372	\$16,254	\$17,136	\$18,018	\$18,900	\$19,782	\$20,664
26'	\$11,976	\$12,936	\$13,818	\$14,490	\$15,372	\$16,464	\$17,346	\$18,234	\$18,906	\$19,998	\$21,090	\$22,182	\$23,274	\$24,366	\$25,458
31'	\$13,818	\$14,850	\$15,774	\$16,680	\$18,198	\$19,500	\$20,562	\$21,618	\$22,440	\$23,736	\$25,032	\$26,328	\$27,624	\$28,920	\$30,216
36'	\$15,768	\$16,812	\$17,346	\$18,774	\$22,440	\$22,542	\$23,808	\$25,014	\$25,968	\$27,486	\$29,004	\$30,522	\$32,040	\$33,558	\$35,076
41'	\$17,598	\$18,384	\$19,824	\$21,258	\$23,850	\$25,182	\$26,988	\$28,404	\$29,502	\$31,224	\$32,946	\$34,668	\$36,390	\$38,112	\$39,834
46'	\$19,566	\$21,132	\$22,308	\$24,528	\$26,676	\$28,620	\$30,204	\$31,794	\$33,030	\$34,974	\$36,918	\$38,862	\$40,806	\$42,750	\$44,694
51'	\$21,384	\$23,484	\$24,528	\$27,018	\$29,502	\$31,650	\$33,420	\$35,184	\$36,564	\$38,718	\$40,872	\$43,026	\$45,180	\$47,334	\$49,488
56'	\$23,748	\$25,968	\$27,930	\$28,980	\$32,328	\$34,686	\$36,630	\$38,574	\$40,098	\$42,456	\$44,814	\$47,172	\$49,530	\$51,888	\$54,246
61'	\$26,622	\$29,250	\$30,414	\$31,986	\$35,148	\$37,728	\$39,846	\$41,964	\$43,626	\$46,206	\$48,786	\$51,366	\$53,994	\$56,526	\$59,106

NOTE: Frames are 1 foot shorter than roof length-wise

PRICING INCLUDES ROOF ONLY



Add 12 gauge - 10 year warranty on rust throughout the framing while assuming normal care and maintenance on the 12 gauge only. 22 feet wide and up, recommend using 12 gauge material

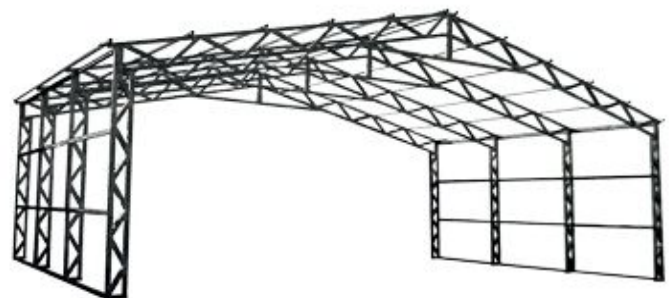

Engineered trusses carry heavier loads and span greater distances!

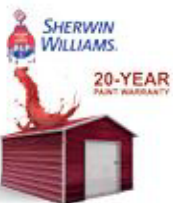

info@acecarports.us
(765) 388-4134

5075 IN-38
New Castle, IN 47362

acecarports.us





LH = Leg Height

BUILDING HEIGHTS	LH	21'	26'	31'	36'	41'	46'	51'	56'	61'
	8'	STD	STD	STD	STD	STD	STD	STD	STD	STD
9'	\$290	\$365	\$435	\$510	\$585	\$655	\$730	\$805	\$880	
10'	\$585	\$730	\$875	\$1,020	\$1,165	\$1,310	\$1,460	\$1,610	\$1,760	
11'	\$875	\$1,095	\$1,310	\$1,530	\$1,750	\$1,970	\$2,185	\$2,400	\$2,615	
12'	\$1,165	\$1,460	\$1,750	\$2,040	\$2,335	\$2,625	\$2,915	\$3,205	\$3,495	
13'	\$1,460	\$1,825	\$2,185	\$2,550	\$2,915	\$3,280	\$3,645	\$4,010	\$4,375	
14'	\$1,750	\$2,185	\$2,625	\$3,060	\$3,500	\$3,935	\$4,375	\$4,815	\$5,255	
15'	\$2,040	\$2,550	\$3,060	\$3,570	\$4,080	\$4,595	\$5,105	\$5,615	\$6,125	
16'	\$2,335	\$2,915	\$3,500	\$4,080	\$4,665	\$5,250	\$5,830	\$6,410	\$6,990	
17'	\$2,625	\$3,280	\$3,935	\$4,595	\$5,250	\$5,905	\$6,560	\$7,215	\$7,870	
18'	\$2,915	\$3,645	\$4,375	\$5,105	\$5,830	\$6,560	\$7,290	\$8,020	\$8,750	

ENCLOSED SIDES (BOTH)	LH	21'	26'	31'	36'	41'	46'	51'	56'	61'
	8'	\$1,175	\$1,475	\$1,765	\$2,055	\$2,400	\$2,650	\$2,950	\$3,250	\$3,550
9'	\$1,280	\$1,605	\$1,960	\$2,335	\$2,730	\$2,890	\$3,215	\$3,540	\$3,865	
10'	\$1,440	\$1,815	\$2,210	\$2,635	\$3,070	\$3,255	\$3,630	\$4,005	\$4,380	
11'	\$1,610	\$2,015	\$2,460	\$2,925	\$3,410	\$3,630	\$4,035	\$4,440	\$4,845	
12'	\$1,765	\$2,235	\$2,720	\$3,230	\$3,765	\$4,000	\$4,470	\$4,940	\$5,410	
13'	\$1,930	\$2,415	\$2,890	\$3,370	\$3,880	\$4,325	\$4,805	\$5,285	\$5,765	
14'	\$2,100	\$2,625	\$3,150	\$3,675	\$4,205	\$4,730	\$5,255	\$5,780	\$6,305	
15'	\$2,250	\$2,810	\$3,370	\$3,930	\$4,485	\$5,045	\$5,605	\$6,165	\$6,725	
16'	\$2,420	\$3,030	\$3,635	\$4,245	\$4,850	\$5,460	\$6,065	\$6,670	\$7,275	
17'	\$2,585	\$3,230	\$3,880	\$4,530	\$5,175	\$5,825	\$6,470	\$7,115	\$7,760	
18'	\$2,745	\$3,435	\$4,125	\$4,810	\$5,500	\$6,190	\$6,875	\$7,560	\$8,245	

ENCLOSED ENDS (PER END)

	32'	34'	36'	38'	40'	42'	44'	46'	48'	50'	52'	54'	56'	58'	60'
8'	\$3,030	\$3,265	\$3,500	\$3,740	\$3,970	\$4,210	\$4,455	\$4,690	\$4,915	\$5,175	\$5,435	\$5,695	\$5,955	\$6,215	\$6,475
9'	\$3,385	\$3,465	\$3,700	\$3,945	\$4,185	\$4,425	\$4,660	\$4,900	\$5,135	\$5,380	\$5,625	\$5,870	\$6,115	\$6,360	\$6,605
10'	\$3,500	\$3,740	\$4,010	\$4,285	\$4,535	\$4,795	\$5,070	\$5,320	\$5,590	\$5,875	\$6,130	\$6,365	\$6,600	\$6,835	\$7,070
11'	\$3,760	\$3,995	\$4,235	\$4,470	\$4,700	\$4,950	\$5,185	\$5,425	\$5,660	\$5,895	\$6,160	\$6,445	\$6,730	\$7,015	\$7,255
12'	\$4,035	\$4,195	\$4,440	\$4,675	\$4,915	\$5,150	\$5,385	\$5,630	\$5,875	\$6,105	\$6,335	\$6,565	\$6,795	\$7,025	\$7,300
13'	\$4,205	\$4,455	\$4,690	\$4,915	\$5,170	\$5,425	\$5,645	\$5,880	\$6,105	\$6,365	\$6,625	\$6,885	\$7,145	\$7,405	\$7,665
14'	\$4,440	\$4,675	\$4,915	\$5,150	\$5,395	\$5,630	\$5,865	\$6,105	\$6,340	\$6,575	\$6,810	\$7,045	\$7,280	\$7,515	\$7,750
15'	\$4,675	\$4,900	\$5,135	\$5,395	\$5,615	\$5,850	\$6,090	\$6,320	\$6,575	\$6,805	\$7,035	\$7,265	\$7,495	\$7,725	\$7,955
16'	\$4,915	\$5,120	\$5,355	\$5,630	\$5,830	\$6,075	\$6,310	\$6,545	\$6,820	\$7,025	\$7,230	\$7,435	\$7,640	\$7,845	\$8,050
17'	\$5,150	\$5,340	\$5,580	\$5,865	\$6,050	\$6,295	\$6,530	\$6,770	\$7,065	\$7,240	\$7,415	\$7,590	\$7,765	\$7,940	\$8,115
18'	\$5,385	\$5,565	\$5,800	\$6,105	\$6,280	\$6,510	\$6,745	\$6,990	\$7,290	\$7,450	\$7,610	\$7,770	\$7,930	\$8,090	\$8,250

Roll-Up Commercial

Garage Doors

(CHAIN HOST)

10' x 12'	\$1,400
12' x 12'	\$1,600
12' x 14'	\$1,800

Garage Doors

6' x 6'	\$650
8' x 7'	\$800
9' x 7'	\$850
10' x 8'	\$1,000
10' x 10'	\$1,100
10' x 12'	\$1,500
12' x 12'	\$1,800
12' x 14'	\$2,000
14' x 14'	\$2,800

Garage Doors

16' x 10'	\$3,500
16' x 12'	\$3,800
16' x 14'	\$4,100
16' x 16'	\$5,100

WALK-IN DOORS

32" x 72"	\$325
34" x 76" ⁹ Lite	\$850
36" x 80"	\$375

WINDOWS

24" x 36"	\$175
30" x 36"	\$200

- White only
- Garage door on side add \$200
- Leg height needs to be 1 ft. taller than door height

We now offer garage doors in different colors for 25% more.
Colors: green, brown, red, pewter grey and light stone.

Prices are subject to change without notice